

PLAN SHOWING THE REVISED
DRAFT LAYOUT IN SY.NO'S 239,240,247 & 249.
OF BAHADURPALLY (V),
DUNDIGAL-GANDIMASAMMA(M) ,
MEDCHAL MALKAJGIRI DIST .

TOTAL SITE AREA : 162196 Sq.mts.
193980 Sq.Yds.
(Ac 40 - 03 Gt)

NO.OF PLOTS : 221 No's

LAND USE ANALYSIS		
DESCRIPTION	Sq. yds	Percentage
PLOTTED AREA	102092.00	52.63%
ROAD AREA	53029.00	27.34%
OPEN SPACE	30233.00	15.58%
SOCIAL INFRASTRUCTURE	5077.00	2.62%
UTILITY AREA	3553.00	1.83%
TOTAL AREA	193984.00	100.00 %

SCALE - 1 : 200

REFERENCE

- LAYOUT BOUNDARY
- EXISTING ROADS
- MASTER PLAN ROADS
- PROPOSED ROADS

CHIEF PLANNING OFFICER DIRECTOR - I (PLG)

JUNIOR PLANNING OFFICER CHIEF ENGINEER

METROPOLITAN COMMISSIONER

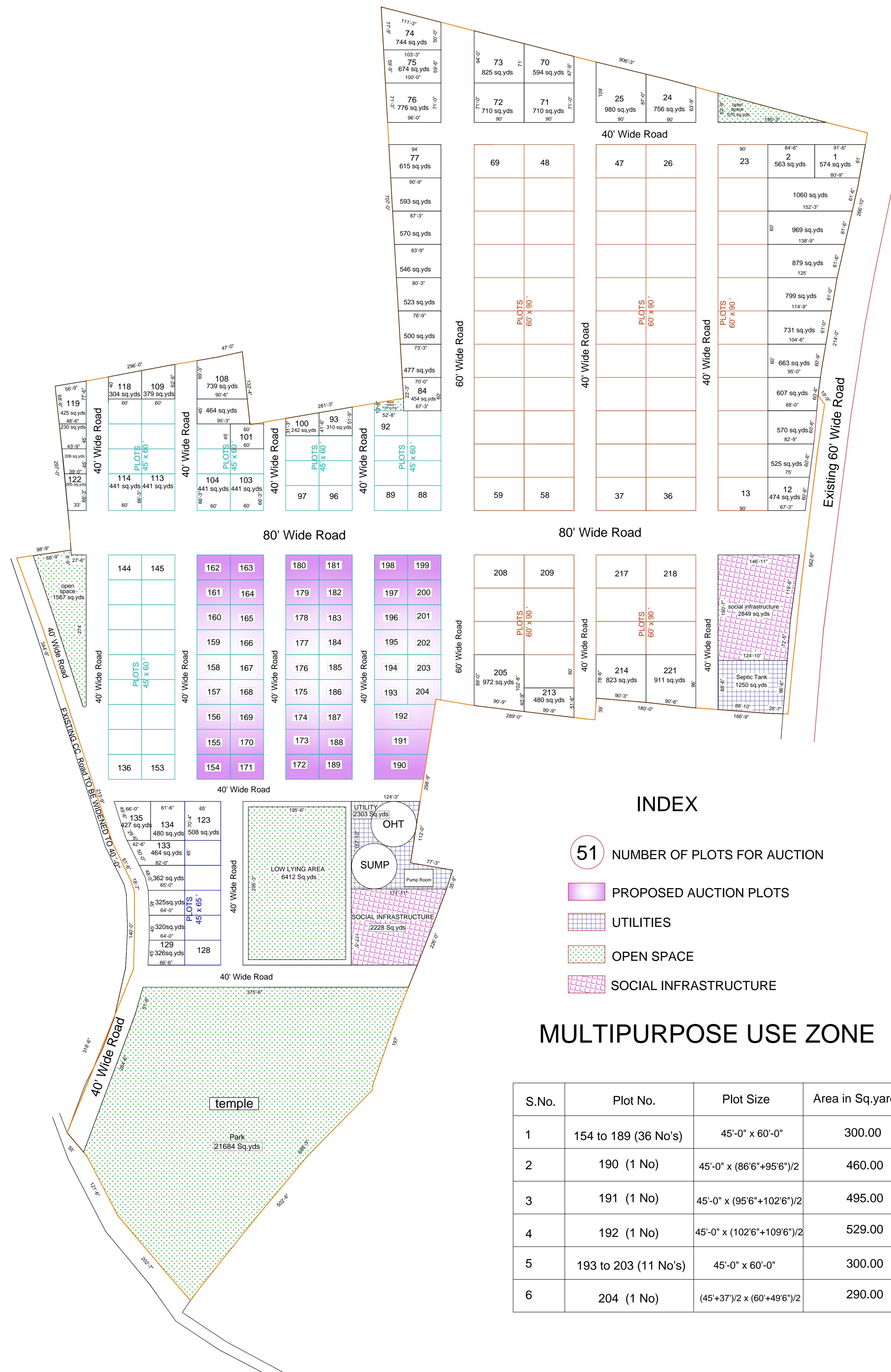

INDEX

- NUMBER OF PLOTS FOR AUCTION
- PROPOSED AUCTION PLOTS
- UTILITIES
- OPEN SPACE
- SOCIAL INFRASTRUCTURE

MULTIPURPOSE USE ZONE

S.No.	Plot No.	Plot Size	Area in Sq.yards
1	154 to 189 (36 No's)	45'-0" x 60'-0"	300.00
2	190 (1 No)	45'-0" x (86'6"+95'6")/2	460.00
3	191 (1 No)	45'-0" x (95'6"+102'6")/2	495.00
4	192 (1 No)	45'-0" x (102'6"+109'6")/2	529.00
5	193 to 203 (11 No's)	45'-0" x 60'-0"	300.00
6	204 (1 No)	(45'+37')/2 x (60'+49'6")/2	290.00